

COUPALEX Hydraulic inter-row mower

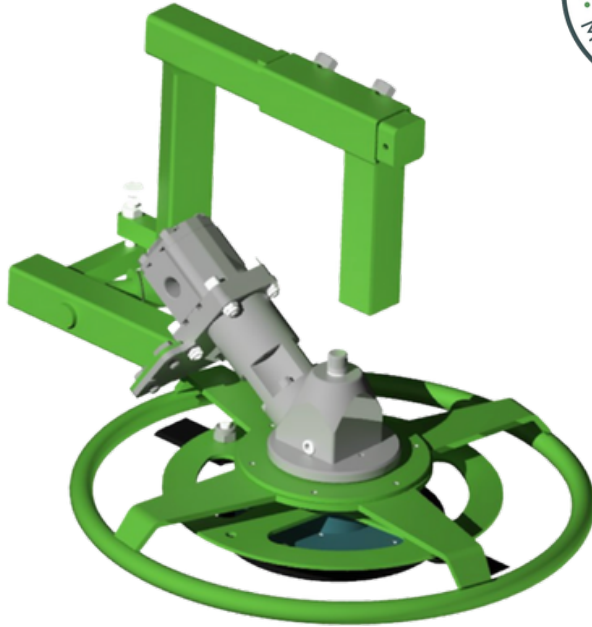

I WEED MY VINEYARD: LIGHTWEIGHT TILLING IMPLEMENT
Between two plowings, when it is necessary to mow.



SUPPORTS

MULTIFUNCTIONAL PARALLELOGRAM
MECHANICAL DELETION

SUPPORT
By perches



SUPPORT
By Gogues



80 kg for each pair of lawnmowers
40 kg per pair of mower blades



All vine widths

The COUPALEX mower trims grass near the ground. It is equipped with a versatile parallelogram linkage that facilitates the mechanical retraction of the tool (feeler). The airflow generated by the rotating blades elevates the grass prior to cutting. Its right-angle drive positions the engine and hoses away from the cutting head, thereby safeguarding the berries.

BENEFITS

- Effortless and efficient installation on a multifunctional stand.
- The motor and hoses are positioned away from the bays due to the right-angle drive.
- Utilize with or without a probe, contingent upon the shape and age of the feet.
- Foot bypass through the upper freewheel
- Plate adjustment through the free lower bowl
- Cutting diameter: 400 mm
- Low flow rate (25-30 L/min at 180 bar)
- Mass gathering
- Knife ventilation

Website for additional
information



Manufacturing facility and exhibition space
SOUSLIKOFF Concept

ZA Terre de Pont, 33460 Arcins
05 64 37 12 61

contact@souslikoff.com
www.souslikoff.com

COUPALEX Hydraulic inter-row mower



TECHNICAL SPECIFICATIONS AND OPTIONS



STREAMLINED ASSEMBLY IN TWO CLICKS



DOWNLOAD THE SOUSLI GUIDE MOBILE APPLICATION

YOUR ASSISTANT FOR THE ASSEMBLY, ADJUSTMENT, AND MAINTENANCE OF YOUR SOUSLIKOFF TOOLS.



Should specific maintenance operations be unfeasible for your distributor due to insufficient technical resources, SOUSLIKOFF is available to undertake them. We recommend reaching out to your distributor.

OUR SELECTION

1 Tool Holder for 4 Tools



SCAN

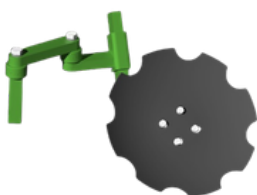

VITALEX (mechanical)
Records



DECALEX (mechanical)
Inter-vine cultivator



BINALEX (mechanical)
Hoe blade



COUPALEX (hydraulics)
Inter-row mower

